

Out Parcel For Lease on Oslo Road & 27th Ave.

2950 9th Street SW
Vero Beach, FL 32968

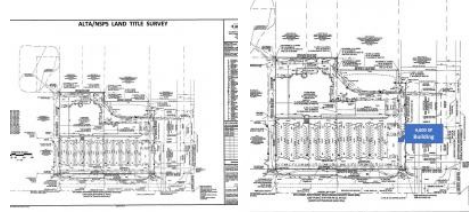

Status: Active
Price: \$2.00 SF per Year
MLS Number: 246099
Type: Commercial - For Lease

Lot Size: 4,600 SF Retail
Type of Electric: FPL
Zoning Type: General Commercial

Out-Parcel is already site plan approved for 4.600 SF Restaurant.

The total number of parking spaces 87

Traffic Volume 21,184

The out parcel is in front of Winn-Dixie

Next Door to Dunkin donuts

View Property Online

<https://properties.millscommercial.net/property/197>

Mills Commercial Real Estate Group, LLC

Phone: 772-562-0018
bmills@millscommercial.net
www.millscommercial.net

The accuracy of all information, regardless of source, including but not limited to square footages and lot sizes, is deemed reliable but is not guaranteed and should be independently verified through personal inspection and/or with the appropriate professionals. The information at this site is provided solely for informational purposes and does not constitute an offer to sell, rent, or advertise real estate outside the state in which the owner of the site is licensed. The owner is not making any warranties or representations concerning any of these properties including their availability. Information at this site is deemed reliable but not guaranteed and should be independently verified.